

Grounds Maintenance

Grp 98 -Joannie Watch/Avenue & Great Carbona Close



NOTES:
 1. All dimensions must not be taken from a drawing.
 2. The ground surface level is indicated on all ground drawings. Documents and information prepared by the architect, other than drawings and specifications, shall be subject to the same conditions of use as the drawings and specifications.
 3. All dimensions are given in millimetres unless otherwise stated.
 4. All dimensions are given in millimetres unless otherwise stated.
 5. All dimensions are given in millimetres unless otherwise stated.
 6. All dimensions are given in millimetres unless otherwise stated.
 7. All dimensions are given in millimetres unless otherwise stated.

REVISIONS	
REV C	23.05.16 Plot 11/20 roof plan amended to show stepped roof

Vounder Close, St Ives, TR26

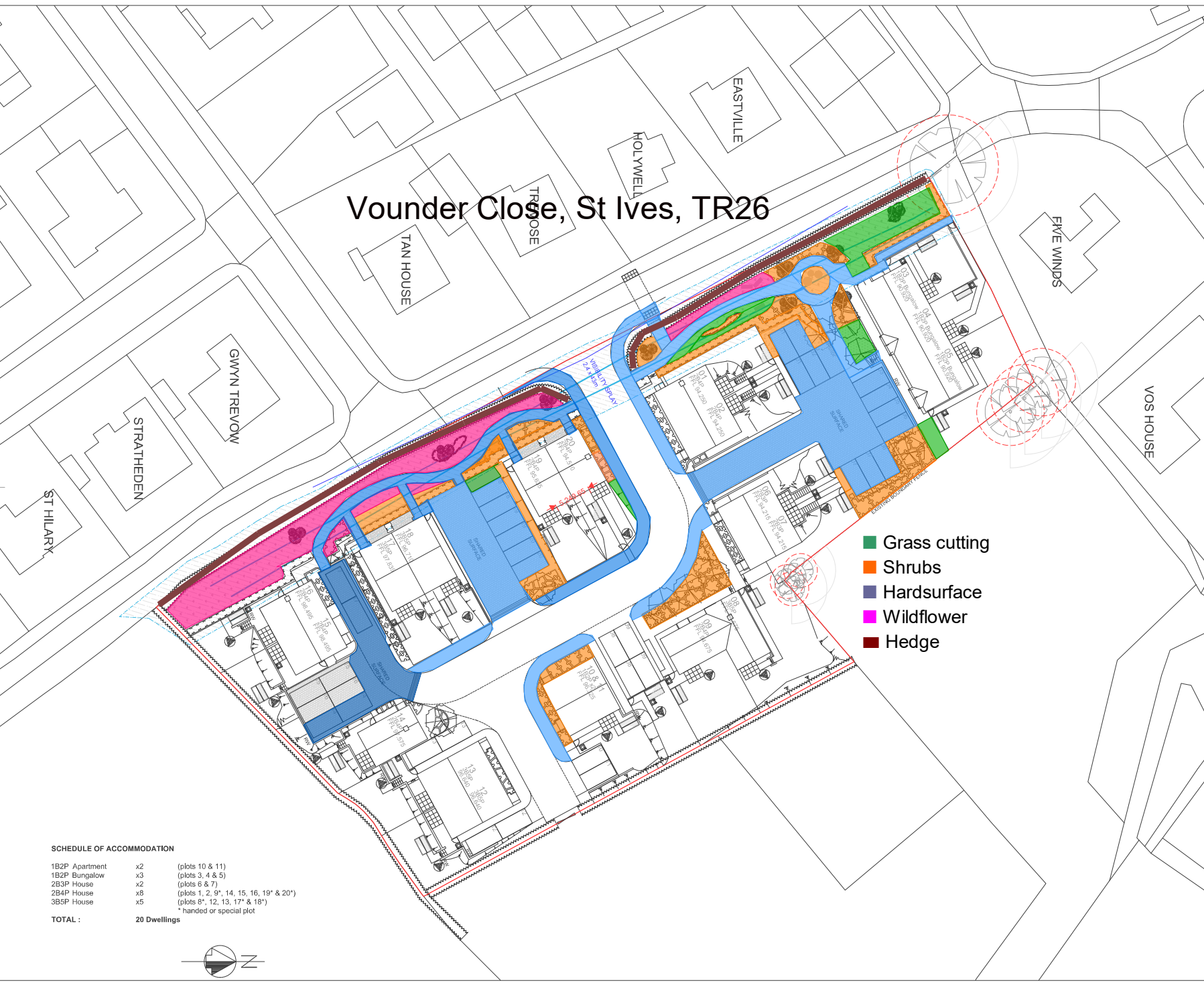

- Grass cutting
- Shrubs
- Hardsurface
- Wildflower
- Hedge

KEY	
	EXISTING TREE (RETAINED)
	ROOT PROTECTION AREA
	PROPOSED TREE
	MULTI-STEM HAZEL SHRUBS
	RETAINING WALL
	HEDGEBANK
	HEDGE
	SHRUBS & GROUNDCOVER
	BULBS
	WILDFLOWER MIX
	GRASS
	BOUND GRAVEL
	PERMEABLE PAVING
	PATIO
	GAS EASEMENT



ERIC COLE ARCHITECTURE

Eric Cole Ltd., 15 The Woolmarket, Cirencester, Gloucestershire GL7 2PR
 T: +44 (0)1285 641234 E: mail@ericcole.co.uk W: www.ericcole.co.uk

SCHEDULE OF ACCOMMODATION

1B2P Apartment	x2	(plots 10 & 11)
1B2P Bungalow	x3	(plots 3, 4 & 5)
2B3P House	x2	(plots 6 & 7)
2B4P House	x8	(plots 1, 2, 9*, 14, 15, 16, 19* & 20*)
3B5P House	x5	(plots 8*, 12, 13, 17* & 18*)
TOTAL :	20 Dwellings	* handed or special plot

